



Registration No: ..... 1 .....

# SAMPLE TEST FOR SALE

Surname: .....

Copyright of The Latymer School

First Name: .....

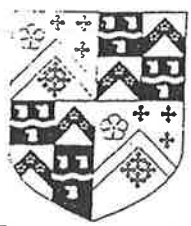

QUI PATIATUR VINCAT

## THE LATYMER SCHOOL

### MATHEMATICS ENTRANCE TEST

Time allowed : One hour

Read these instructions before you start:

- There are **50 questions** in this paper and each question is worth **one mark**. Work through the questions in the order that they appear. There may be some questions that you cannot do. Leave these and go on to the next question: you may have time to return to them at the end for another attempt.
- Use the space by each question to work out your answer. The blank pages may be used for working if there is not enough space by the question.
- You may use a pen or a pencil for this test. You need a short ruler.
- **Calculators are not allowed.**

Mark	Examiner



LATYMER MATHEMATICS TEST

Each question is worth 1 mark, if you find one that you cannot do go on to the next. Calculators are not allowed

1. Add

$$\begin{array}{r} 759 \\ 453 \\ 928 \\ \hline \\ \hline \end{array}$$

2. Work out  $1015 - 138$

-----

3. Work out  $48 \times 11$

-----

As a special offer, 6 oranges cost 84 pence.

4. How much would 2 oranges cost ?

-----

5. How much would 57 oranges cost ?

-----

6. 8 glasses of cola can be poured from one large bottle.

For a disco enough cola has to be bought for all of the 162 pupils to have 2 glasses each.

How many large bottles must be bought?

ANSWERS

-----

-----

-----

-----

-----

-----



ANSWERS

For questions 7, 8, and 9 write down the next number in the pattern.

7.                    1        4        9        16        .....

8.                    17      12      7        2        .....

9.                    2        7        9        16      25      .....

10. The speed limit 30 miles per hour will soon become 48 kilometres per hour.

What will a speed of 70 miles per hour become ?

11. Complete the shape below so that the dotted line is a line of symmetry.

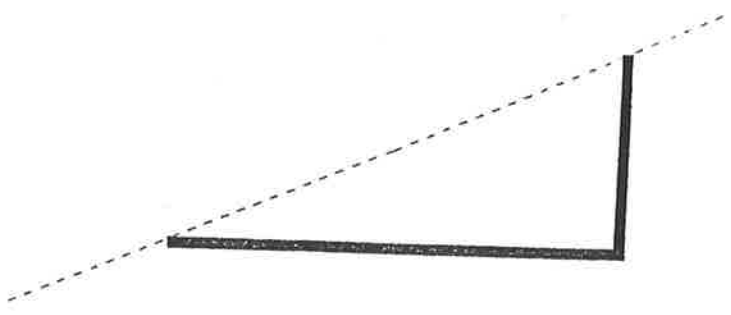

12. Circle the numbers below which are prime numbers.

- 27    29    31    39    49

13. A quiz team of three pupils is to be picked from Ali, Bev, Ceri, and Dave

How many different teams can be picked ?

A vertical column on the right side of the page, divided into sections by horizontal dashed lines. The top section is labeled 'ANSWERS' and is currently blank. Below it is a large, shaded rectangular area, likely intended for students to write their answers. The bottom section is also blank.

ANSWER

14. An apple weighs 262 grams.  
If I weigh 4 of them, how much more than a Kilogram will this come to?  
Give the answer in grams.

15. In a race, competitors have to cycle from P to R, and then back to finish at Q. How far is this?

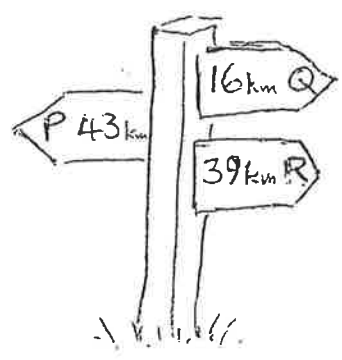

16.

The spider is at (180, 10)  
Where is the fly?

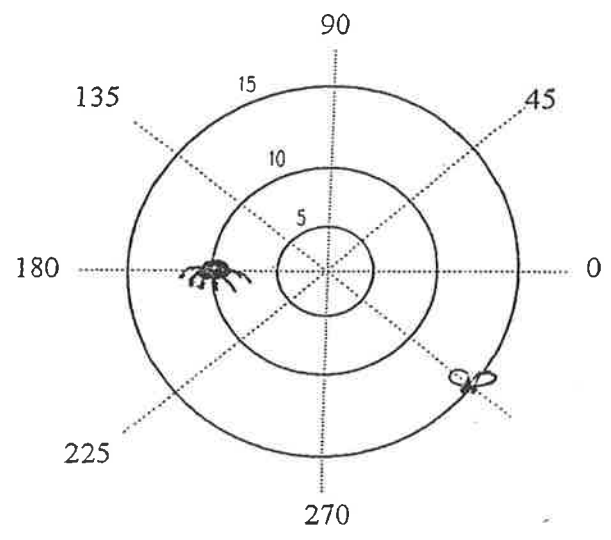

( , )

17. A gardener makes the following table to show what plants are in flower. Some of the numbers are missing.  
How many yellow tulips are there?  
Write the answer in the answer space as with the other questions.

	red	yellow	TOTAL
roses	7		11
tulips			
TOTAL	35		52



18.



4.5cm

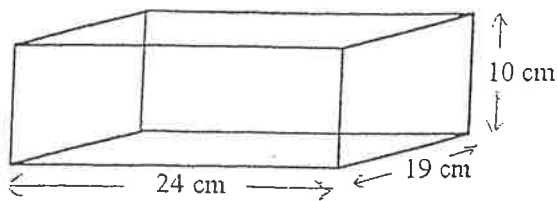

How many oranges will fit into this closed box ?

19. Find 75% of £ 120.

20. If

$$\frac{4}{10} = \frac{\#}{25}$$

what does # stand for ?

21. Arrange the numbers  
0.37 , 0.256 , 0.4 , 0.07 ,  
in order, smallest first.

Answer here .....

22. I think of a number. . .multiply by 4 ...subtract 9  
and then get the same number as I started with.

What was the number ?

23. Judges award an ice skater scores of

5.7 5.8 5.7 5.4 5.9 5.5 5.8

The highest and lowest scores are ignored, then the  
average is found for those that are left.

What is the average for the skater worked out in  
this way ?

ANSWERS

Blank area for writing answers, with a shaded horizontal band in the middle.



24. What does  $[\ ]$  stand for if

$$13 - [\ ] = 5 + [\ ] \quad ?$$

25. There are 3 red , 7 white , and 2 blue marbles in a bag.

I close my eyes and pick one.

What is the probability that it is blue ?

26. Zeena buys a melon costing £1.45 and 6 apples costing 29p each.

How much change does she get from a £10 note ?

27. Work out  $500 \times 2000$

28.

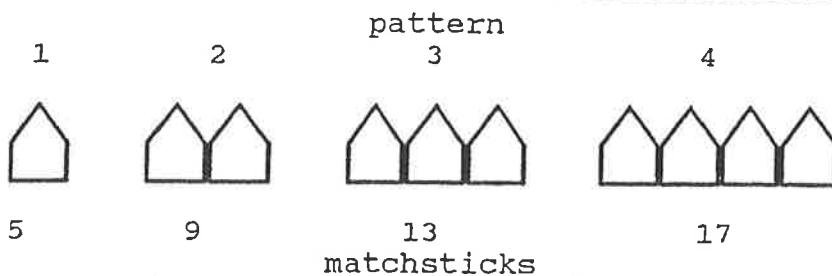

Here are four patterns. How many matchsticks are needed for the 25th pattern ?

29.

Add together

$$\frac{1}{4} + \frac{1}{5}$$

Mrs. Battenberg buys 2 cakes for every person expected at a party, then adds 8 cakes more.

34. How many cakes would she buy for 23 people ?

35. She buys 206 cakes for a special occasion.

How many people are expected ?

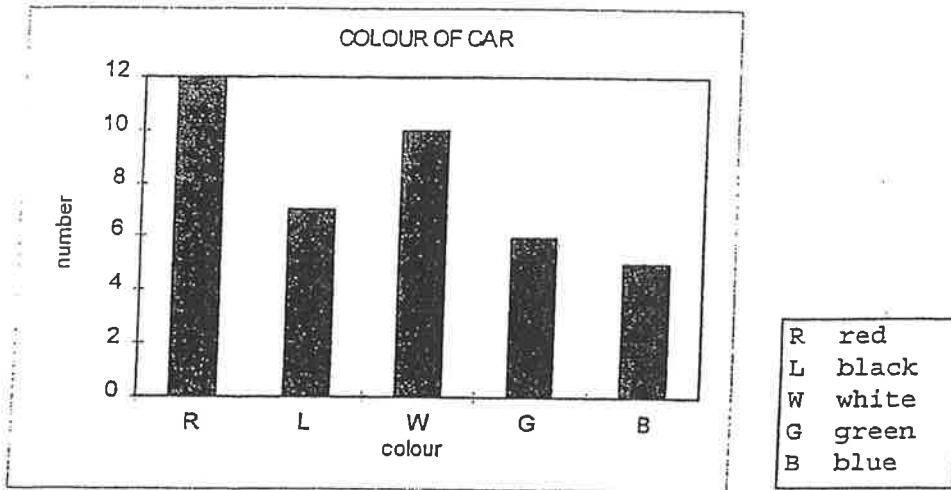

The colour of every car in a car park at 10am is shown in the graph above.

36. How many cars were parked at that time ?

37. What percentage (%) of cars were red ?

38. In another car park there are 336 cars. How many would you expect to be blue ?

39. How many 7's would you type if you typed all the numbers from 1 to 100 ?

%



30.

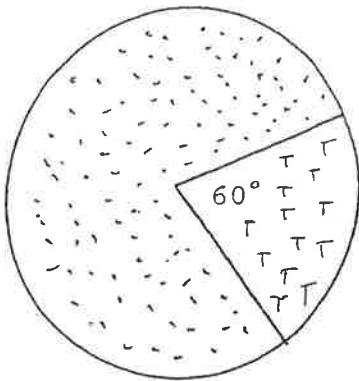

••••• coffee  
T tea

in a survey 600 preferred coffee, how many preferred tea?

31.

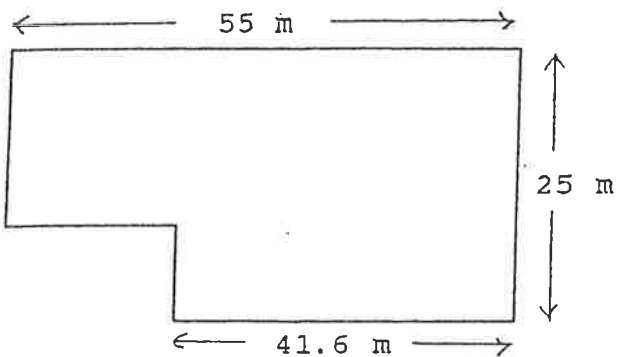

Alex walks all the way round the outside of this field.

How far does he walk ?

2 On a new 3 hour video tape Gayle records 53 mins of Star Trek, followed by a 1 hour 25 min Blur concert. How much time in hrs and mins of blank tape is left?

33.

$199.7 \div 20.23$  is about :

- 100      10      40      5      170

Put a circle round the answer.

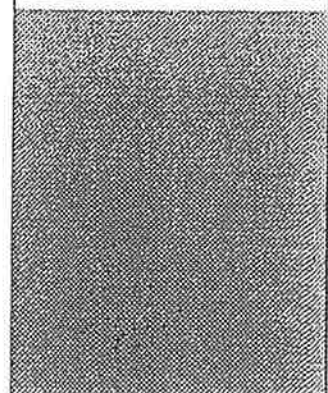





40.

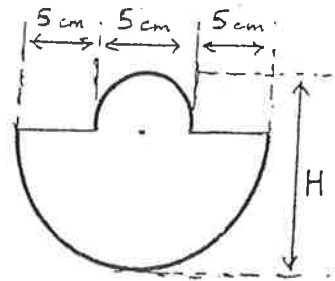

A tile is made from two semi-circles as shown.  
Find the height H in cm.

ANSWERS

41. A racing car can do one lap of a race in 1 min 39 secs.  
At this speed, how long in minutes and seconds would 3 laps take?

42.

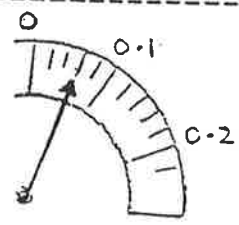

What measurement does the arrow point to?

43. How many degrees are there in the smaller angle between the hands of a clock at 5 o'clock?

44. For a journey to Ponders End taking the shortest time, at what time would you catch the bus at Smithfield?

Smithfield	....	....	....	2111	2131	2151	2211
Islington Angel	⊖	....	....	2116	2136	2156	2216
Highbury & Islington Station	⊖	⚡	....	2121	2141	2201	2221
Holloway Nags Head	....	....	....	2127	2147	2207	2227
Manor House Station	⊖	....	....	2135	2155	2215	2235
Tottenham Swan	....	....	....	2144	2204	2224	2243
Lower Edmonton Station	⚡	....	....	2158	2218	2238	2256
Ponders End Southbury Road	....	....	....	2206	2226	2245	2303

45. In how many different ways can you multiply two whole numbers together to get 36?

ANSWERS

---



---



---



---



---



---



---



---



---



---



46.

ribbon

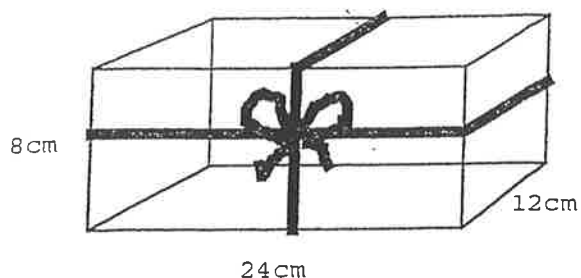

What length of ribbon is used to tie this present ?  
Add an extra 15cm for the bow.

ANSWERS

47. Old people will remember that before 1971,  
1 shilling = 12 pence  
To see a film cost 1 shilling and 9 pence, Ice cream cost 6 pence, and bus fare was 10 pence.  
How much was this altogether in shillings and pence?

48. 4 pencils and 3 rubbers cost 79 p  
3 pencils and 2 rubbers cost 57 p  
How much would 1 pencil and 1 rubber cost ?

49. In a hockey competition there are seven teams.  
Each team has to play every other team just once.  
How many matches will there be ?

50. In a certain family each boy has the same number of brothers and sisters.  
Each girl has twice as many brothers as sisters.  
How many boys and girls are there in the family ?

BOYS

GIRLS

## Specimen Mathematics Test 1 - Answer Sheet

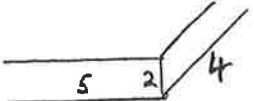
1.	2140	basic addition	✓	26.	£6.81	6.81, 681p accepted	✓
2.	877	subtraction with 'borrowing'	✓	27.	1,000,000	or a million	✓
3.	528	2 digit by 2 digit multiplication as in KS2	✓	<b>28.</b>	101	$5 + 24 \times 4$	✓
4.	28p	$84/3$ '28' accepted	✓	29.	$9/20$	0.45 accepted	✓
5.	£7.98	798p, 798, 7.98 accepted	✗	<b>30.</b>	120	$300^\circ$ represents 600 so $60^\circ$ represents 120	✓
6.	41	you have to buy whole bottles	✓	31.	160m	$(55 + 25) \times 2$	✓
7.	25		✓	32.	42 min.	or 0hr 42min	✓
8.	-3		✗	33.	10	$199.7/20.23$ is approx. $200/20$	✓
9.	41	add previous 2 numbers	✗	34.	54		✓
<b>10.</b>	112	$30 \rightarrow 48$ , so $10 \rightarrow 16$ , so $70 \rightarrow 7 \times 16$	✓	35.	99		✗
11.		need not be too accurate	✓	36.	40	$12+7+10+6+5$	✓
12.	29,31		✗	<b>37.</b>	30%	$12/40 = 3/10 = 30/100$	✓
13.	4		✗	38.	42		✓
14.	48 grams	48 accepted	✓	39.	20	do not forget 70, 71, etc	✓
15.	105 km	105 accepted	✗	<b>40.</b>	10cm	$1/2 \times 15 + 1/2 \times 5$	✓
16.	$(315, 15)$	add $45^\circ$ to $270^\circ$	✓	41.	4min 57sec	NOT 4min 17sec	✓
17.	13	must be extracted from the table and put in the answer space	✓	42.	0.06		✓
<b>18.</b>	40	 (a genius may say 42)	✓	43.	150		✓
19.	£90	or just 90	✓	44.	2211		✗
20.	10	$10/25$ accepted	✗	45.	5 (or 9)	$1 \times 36, 2 \times 18, 3 \times 12, 4 \times 9, 6 \times 6$ $(9 \times 4, 12 \times 3, 18 \times 2, 36 \times 1)$	✓
21.	0.07, 0.256, 0.37, 0.4		✓	46.	127cm	1.27m, 127 accepted	✓
22.	3	by trial and error, or algebra	✓	47.	3 shillings 1 penny	37p <b>NOT</b> accepted	✓
23.	5.7	$28.5/5$	✗	<b>48.</b>	22p	subtract line 2 from line 1	✓
24.	4	by trial and error, or algebra	✓	<b>49.</b>	21	NOT 42 (A v B is same as B v A)	✓
25.	$1/6$	$2/12, 1$ in 6, $2$ in 12, 1:6, 2:12, 17% all accepted	✓	<b>50.</b>	4 boys, 3 girls	by trial and error, or impressive algebra	✓

50 questions all score 1 mark each. Those in **bold** are more difficult than most.

62%  
21/34  
30

